

LEVELING MOUNTS

NSF RECOGNIZED STAINLESS STEEL

STAINLESS

NSF

POLYPROPYLENE BASE

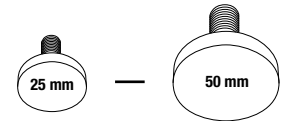
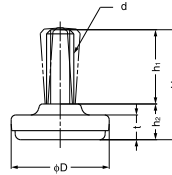
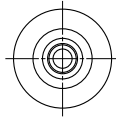

Base diameter range

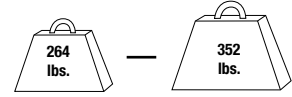

Static load range (per mount)

Material: Cover - 304 stainless steel
 Bolt - Steel
 Base - Polypropylene

Finish: Cover - Satin
 Bolt - Chrome
 Base - White

PART NUMBER	PRIMARY DIMENSIONS					MOUNTING		MAXIMUM STATIC LOAD
	BASE DIAMETER "D"	OVERALL HEIGHT "H"	STUD LENGTH "h1"	BASE CAP HEIGHT "h2"	BASE HEIGHT "c"	THREAD SIZE		
MH-25	25 (.098")	40 (1.57")	27 (1.06")	13 (.51")	9 (.35")	5/16-18	264 lbs.	
MH-32	32 (1.26")	40 (1.57")	27 (1.06")	13 (.51")	9 (.35")	3/8-16	352 lbs.	
MH-36	36 (1.41")	40 (1.57")	27 (1.06")	13 (.51")	9 (.35")	3/8-16	352 lbs.	
MH-40	40 (1.57")	40 (1.57")	27 (1.06")	13 (.51")	9 (.35")	3/8-16	352 lbs.	
MH-50	50 (1.97")	50 (1.97")	34 (1.34")	16 (.63")	11 (.43")	1/2-12	352 lbs.	

NSF

STAINLESS BASE

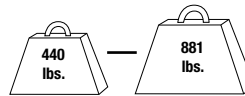
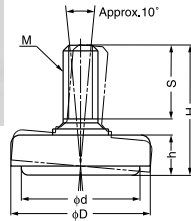

Static load range (per mount)

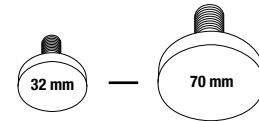

Base diameter range

Material: 304 stainless steel
Finish: Satin

PART NUMBER	PRIMARY DIMENSIONS				MOUNTING		MAXIMUM STATIC LOAD
	"D"	"d"	"H"	"h"	"S"	THREAD SIZE	
MKPS-32N3	32 (1.26")	27 (1.06")	36 (1.41")	11 (.43")	21 (.83")	3/16-18	440 lbs.
MKPS-40N3	40 (1.57")	34 (1.34")	37 (1.46")	11.5 (.45")	21 (.83")	3/16-18	704 lbs.
MKPS-50N3	50 (1.97")	44 (1.73")	37.5 (1.48")	11.5 (.45")	21 (.83")	3/16-18	792 lbs.
MKPS-60M12	60 (2.36")	54 (2.13")	51.5 (2.03")	11.5 (.45")	35 (1.38")	M12	881 lbs.
MKPS-70M14	70 (2.76")	64 (2.52")	51.5 (2.03")	11.5 (.45")	35 (1.38")	M14	881 lbs.

NSF

NO-SLIP BASE

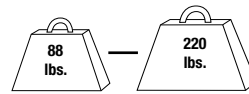
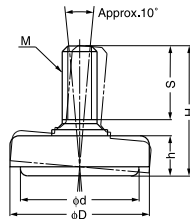

Static load range (per mount)

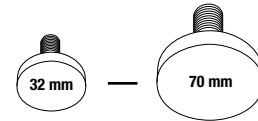

Base diameter range

Material: Body - 304 stainless steel
 Base - Elastomer

Finish: Body - Satin
 Base - Black

PART NUMBER	PRIMARY DIMENSIONS				MOUNTING		MAXIMUM STATIC LOAD
	"D"	"d"	"H"	"h"	"S"	THREAD SIZE	
MKRS-32N3	32 (1.26")	27 (1.06")	36 (1.41")	11 (.43")	21 (.83")	3/16-18	88 lbs.
MKRS-40N3	40 (1.57")	34 (1.34")	37 (1.46")	11.5 (.45")	21 (.83")	3/16-18	176 lbs.
MKRS-50N3	50 (1.97")	44 (1.73")	37.5 (1.48")	11.5 (.45")	21 (.83")	3/16-18	220 lbs.
MKRS-60M12	60 (2.36")	54 (2.13")	51.5 (2.03")	11.5 (.45")	35 (1.38")	M12	220 lbs.
MKRS-70M14	70 (2.76")	64 (2.52")	51.5 (2.03")	11.5 (.45")	35 (1.38")	M14	220 lbs.

LEVELING MOUNTS, RECOGNIZED STAINLESS STEEL

LEVELING MOUNTS METAL BASE

- Swivels 10° in all directions.
- Furnished with jamb nuts.
- Steel or stainless steel.
- Standard plain or non-skid base.

METAL BASE LEVELING MOUNTS

PROJECTING STUD

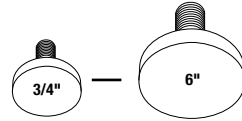

Base diameter range

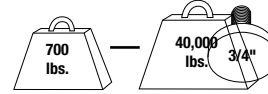

Static load range
(per mount)



PROJECTING STUD - PART NUMBERS				PRIMARY DIMENSIONS		MOUNTING		MAXIMUM STATIC LOAD (LBS.)
STEEL		STAINLESS STEEL		BASE DIAMETER "D"	TOTAL LENGTH "T"	THREAD SIZE "S"	THREAD LENGTH "L"	
STANDARD	NON-SKID	STANDARD	NON-SKID					
79-503-10	79-603-10	79-503-15	79-603-15	.75"	1.53"	10-32	1.00"	700 lbs.
79-503-20	79-603-20	79-503-25	79-603-25		2.53"		1/4-20	
79-514-10	79-614-10	79-514-15	79-614-15	1.00"	1.95"	3/8-16		1.25"
79-514-20	79-614-20	79-514-25	79-614-25		3.20"		1/2-13	2.50"
79-576-20	79-676-20	79-576-25	79-676-25	1.25"	2.88"	5/8-11		2.00"
79-576-40	79-676-40	79-576-45	79-676-45		4.88"		3/4-10	4.00"
79-587-20	79-687-20	79-587-25	79-687-25	1.88"	3.13"	1-8		2.00"
79-587-40	79-687-40	79-587-45	79-687-45		5.13"		1 1/4 - 7	4.00"
79-590-20	79-690-20	79-590-25	79-690-25	2.50"	3.25"	1-8		2.00"
79-590-40	79-690-40	79-590-45	79-690-45		5.25"		3/4-10	4.00"
79-538-20	79-638-20	79-538-25	79-638-25	3.00"	3.50"	1-8		2.00"
79-538-40	79-638-40	79-538-45	79-638-45		5.50"		1-8	4.00"
79-549-30	79-649-30	79-549-35	79-649-35	4.00"	5.38"	1-8		3.50"
79-549-40	79-649-40	79-549-45	79-649-45		6.13"		1 1/4 - 7	4.25"
79-549-60	79-649-60	79-549-65	79-649-65	6.00"	7.88"	1 1/4 - 7		6.00"
79-561-40	79-661-40	79-561-45	79-661-45		6.75"		1 1/4 - 7	4.00"
79-561-60	79-661-60	79-561-65	79-661-65	8.75"	6.00"	6.00"		

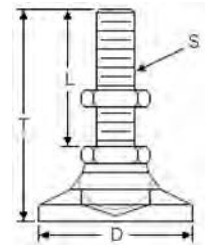

THREADED INSERT

THREADED INSERT - PART NUMBERS				PRIMARY DIMENSIONS		MOUNTING	MAXIMUM STATIC LOAD (LBS.)
STEEL		STAINLESS STEEL		BASE DIAMETER "D"	TOTAL LENGTH "T"	THREAD SIZE "S"	
STANDARD	NON-SKID	STANDARD	NON-SKID				
79-503-00	79-603-00	79-503-05	79-603-05	.75"	.53"	10-32	700 lbs.
79-514-00	79-614-00	79-514-05	79-614-05	1.00"	.70"	1/4-20	1000 lbs.
79-575-00	79-675-00	79-575-05	79-675-05	1.25"	.88"	5/16-18	2000 lbs.
79-576-00	79-676-00	79-576-05	79-676-05		.88"	3/8-16	3500 lbs.
79-587-00	79-687-00	79-587-05	79-687-05	1.88"	1.13"	1/2-13	5000 lbs.
79-590-00	79-690-00	79-590-05	79-690-05	2.50"	1.25"	5/8-11	6000 lbs.
79-538-00	79-638-00	79-538-05	79-638-05	3.00"	1.50"	3/4-10	7000 lbs.
79-549-00	79-649-00	79-549-05	79-649-05	4.00"	5.38"	1-8	20,000 lbs.
79-561-00	79-661-00	79-561-05	79-661-05	6.00"	6.75"	1 1/4 - 7	40,000 lbs.

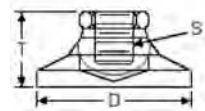

Metric threading is available, please call.
Clear zinc, nickel, and black oxide finishes are also available.

Material and Finish:

Base:

Steel – yellow zinc.
Stainless steel – plain.

Stud or Insert:

Steel – yellow zinc.
Stainless steel – plain.

Note:

Add .125" to total length
for non-skid pad.

LEVELING MOUNTS

NYLON BASE

NYLON BASE LEVELING MOUNTS

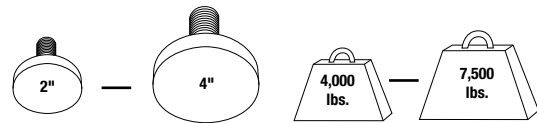

Base diameter range

Static load range
(per mount)

- 15° swivel in all directions.
- Non-corrosive high strength glass filled nylon base.
- Available with or without lag holes.
- Innovative “pop-out” lag holes allow for permanent mounting.
- Available with or without non-skid pad.

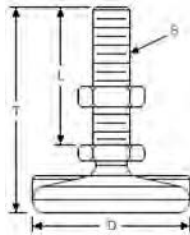

PROJECTING STUD - PART NUMBER				PRIMARY DIMENSIONS		MOUNTING		MAXIMUM STATIC LOAD (LBS.)
STEEL		STAINLESS STEEL		BASE DIAMETER "D"	TOTAL LENGTH "T"	THREAD SIZE "S"	THREAD LENGTH "L"	
STANDARD	NON-SKID	STANDARD	NON-SKID					
79-126-40	79-226-40	79-126-45	79-226-45	2.00"	5.12"	3/8-16	4.00"	4000 lbs.
79-126-60	79-226-60	79-126-65	79-226-65		7.12"		6.00"	
79-126-80	79-226-80	79-126-85	79-226-85		9.12"		8.00"	
79-127-40	79-227-40	79-127-45	79-227-45	2.00"	5.12"	1/2-13	4.00"	4000 lbs.
79-127-60	79-227-60	79-127-65	79-227-65		7.12"		6.00"	
79-127-80	79-227-80	79-127-85	79-227-85		9.12"		8.00"	
79-136-40	79-236-40	79-136-45	79-236-45	3.00"	5.12"	3/8-16	4.00"	5000 lbs.
79-136-60	79-236-60	79-136-65	79-236-65		7.12"		6.00"	
79-136-80	79-236-80	79-136-85	79-236-85		9.12"		8.00"	
79-137-40	79-237-40	79-137-45	79-237-45	3.00"	5.12"	1/2-13	4.00"	5000 lbs.
79-137-60	79-237-60	79-137-65	79-237-65		7.12"		6.00"	
79-137-80	79-237-80	79-137-85	79-237-85		9.12"		8.00"	
79-138-40	79-238-40	79-138-45	79-238-45	3.00"	5.12"	3/4-10	4.00"	5000 lbs.
79-138-60	79-238-60	79-138-65	79-238-65		7.12"		6.00"	
79-138-80	79-238-80	79-138-85	79-238-85		9.12"		8.00"	
79-146-40	79-246-40	79-146-45	79-246-45	4.00"	5.31"	3/8-16	4.00"	3500 lbs.
79-146-60	79-246-60	79-146-65	79-246-65		7.31"		6.00"	
79-146-80	79-246-80	79-146-85	79-246-85		9.31"		8.00"	
79-147-40	79-247-40	79-147-45	79-247-45	4.00"	5.31"	1/2-13	4.00"	5000 lbs.
79-147-60	79-247-60	79-147-65	79-247-65		7.31"		6.00"	
79-147-80	79-247-80	79-147-85	79-247-85		9.31"		8.00"	
79-148-40	79-248-40	79-148-45	79-248-45	4.00"	5.31"	3/4-10	4.00"	7500 lbs.
79-148-60	79-248-60	79-148-65	79-248-65		7.31"		6.00"	
79-148-80	79-248-80	79-148-85	79-248-85		9.31"		8.00"	
79-149-40	79-249-40	79-149-45	79-249-45	4.00"	5.31"	1-8	4.00"	7500 lbs.
79-149-60	79-249-60	79-149-65	79-249-65		7.31"		6.00"	
79-149-80	79-249-80	79-149-85	79-249-85		9.31"		8.00"	

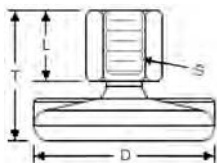

THREADED INSERT - PART NUMBERS				PRIMARY DIMENSIONS		MOUNTING	MAXIMUM STATIC LOAD (LBS.)
STEEL		STAINLESS STEEL		BASE DIAMETER "D"	TOTAL LENGTH "T"	THREAD SIZE "S"	
STANDARD	NON-SKID	STANDARD	NON-SKID				
79-126-00	79-226-00	79-126-05	79-226-05	2.00"	1.63"	5/16-18	4000 lbs.
79-127-00	79-227-00	79-127-05	79-227-05		1.63"	1/2-13	4000 lbs.
79-136-00	79-236-00	79-136-05	79-236-05	3.00"	1.63"	5/16-18	5000 lbs.
79-137-00	79-237-00	79-137-05	79-237-05		1.63"	1/2-13	5000 lbs.
79-138-00	79-238-00	79-138-05	79-238-05	4.00"	1.63"	3/4-10	5000 lbs.
79-146-00	79-246-00	79-146-05	79-246-05		1.63"	5/16-18	3500 lbs.
79-147-00	79-247-00	79-147-05	79-247-05		1.63"	1/2-13	5000 lbs.
79-148-00	79-248-00	79-148-05	79-248-05	4.00"	1.63"	3/4-10	7500 lbs.
79-149-00	79-249-00	79-149-05	79-249-05		1.63"	1-8	7500 lbs.

Metric threading is available, please call.

Note:
Add .06" to total length
for non-skid base.

Material and Finish:

Base: Nylon, Black

Stud or Insert:

Steel – clear zinc plated

Stainless steel – plain

LEVELING MOUNTS

DERLIN BASE

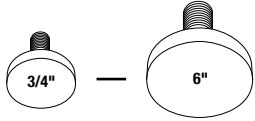

Base diameter range

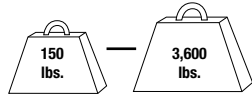

Static load range
(per mount)

DELIN BASE LEVELING MOUNTS

- Swivels 10° in all directions.
- Non-corrosive delrin base, excellent for washdown environment.
- Available with steel or stainless steel studs or inserts.
- Available with or without non-skid pad.



PROJECTING STUD

PROJECTING STUD - PART NUMBERS				PRIMARY DIMENSIONS		MOUNTING		MAXIMUM STATIC LOAD (LBS.)
STEEL		STAINLESS STEEL		BASE DIAMETER "D"	TOTAL LENGTH "T"	THREAD SIZE "S"	THREAD LENGTH "L"	
STANDARD	NON-SKID	STANDARD	NON-SKID					
79-703-10	79-803-10	79-703-15	79-803-15	.75"	1.53"	10-32	1.00"	150 lbs.
79-703-20	79-803-20	79-703-25	79-803-25		2.53"		2.00"	
79-714-10	79-814-10	79-714-15	79-814-15	1.00"	1.95"	1/4-20	1.25"	200 lbs.
79-714-20	79-814-20	79-714-25	79-814-25		3.20"		2.50"	
79-776-20	79-876-20	79-776-25	79-876-25	1.25"	2.88"	3/8-16	2.00"	300 lbs.
79-776-40	79-876-40	79-776-45	79-876-45		4.88"		4.00"	
79-787-20	79-887-20	79-787-25	79-887-25	1.88"	3.13"	1/2-13	2.00"	700 lbs.
79-787-40	79-887-40	79-787-45	79-887-45		5.13"		4.00"	
79-790-20	79-890-20	79-790-25	79-890-25	2.50"	3.25"	5/8-11	2.00"	1200 lbs.
79-790-40	79-890-40	79-790-45	79-890-45		5.25"		4.00"	
79-738-20	79-838-20	79-738-25	79-838-25	3.00"	3.50"	3/4-10	2.00"	1800 lbs.
79-738-40	79-838-40	79-738-45	79-838-45		5.50"		4.00"	
79-749-30	79-849-30	79-749-35	79-849-35	4.00"	5.38"	1-8	3.50"	2400 lbs.
79-749-40	79-849-40	79-749-45	79-849-45		6.13"		4.25"	
79-749-60	79-849-60	79-749-65	79-849-65		7.88"		6.00"	
79-761-40	79-861-40	79-761-45	79-861-45		6.75"		4.00"	
79-761-60	79-861-60	79-761-65	79-861-65	6.00"	8.75"	1 1/4 - 7	6.00"	3600 lbs.

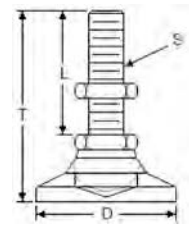

THREADED INSERT

THREADED INSERT - PART NUMBERS				PRIMARY DIMENSIONS		MOUNTING	MAXIMUM STATIC LOAD (LBS.)
STEEL		STAINLESS STEEL		BASE DIAMETER "D"	TOTAL LENGTH "T"	THREAD SIZE "S"	
STANDARD	NON-SKID	STANDARD	NON-SKID				
79-703-00	79-803-00	79-703-05	79-803-05	.75"	.53"	10-32	150 lbs.
79-714-00	79-814-00	79-714-05	79-814-05	1.00"	.70"	1/4-20	200 lbs.
79-775-00	79-875-00	79-775-05	79-875-05	1.25"	.88"	5/16-18	250 lbs.
79-776-00	79-876-00	79-776-05	79-876-05		.88"	3/8-16	300 lbs.
79-787-00	79-887-00	79-787-05	79-887-05	1.88"	1.13"	1/2-13	700 lbs.
79-790-00	79-890-00	79-790-05	79-890-05	2.50"	1.25"	5/8-11	1200 lbs.
79-738-00	79-838-00	79-738-05	79-838-05	3.00"	1.50"	3/4-10	1800 lbs.
79-749-00	79-849-00	79-749-05	79-849-05	4.00"	5.38"	1-8	2400 lbs.
79-761-00	79-861-00	79-761-05	79-861-05	6.00"	6.75"	1 1/4 - 7	3600 lbs.

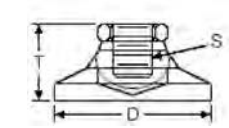

Metric threading is available, please call.
Clear zinc, nickel, and black oxide finishes are also available.

Material and Finish:

Base: Delrin, white.

Stud or Insert:

Steel – yellow zinc plated.

Stainless steel – plain.

Note:
Add .125" to total length for non-skid base.

LEVELING MOUNTS

ANTI-VIBRATION

ANTI-VIBE® MACHINE MOUNTS



- Light, medium and heavy duty configurations.
- Can isolate transmitted vibration up to 98%.
- Protects your machinery.

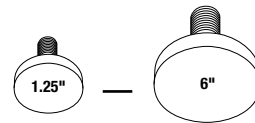

Base diameter range

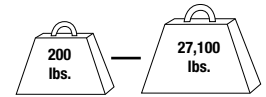

Static load range (per mount)

Material:

Low carbon steel,
or 303 stainless steel

PROJECTING STUD

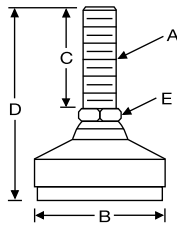

		PROJECTING STUD PART NUMBERS		PRIMARY DIMENSIONS		MOUNTING		MAXIMUM STATIC LOAD (LBS.)
		STEEL	STAINLESS STEEL	BASE DIA. "D"	LENGTH "T"	THREAD SIZE "S"	THREAD LENGTH "L"	
LIGHT DUTY	79-AV1L-200	79-AV1L-205	1.25"	3.50"	3/8 - 16	2.00"	200 LBS.	
	79-AV2L-200	79-AV2L-205	1.88"	3.75"	1/2 - 13	2.00"	500 LBS.	
	79-AV3L-200	79-AV3L-205	2.50"	3.88"	5/8 - 11	2.00"	900 LBS.	
	79-AV4L-200	79-AV4L-205	3.00"	4.13"	3/4 - 10	2.00"	1250 LBS.	
	79-AV5L-350	79-AV5L-355	4.00"	6.00"	1 - 8	3.50"	2250 LBS.	
	79-AV6L-400	79-AV6L-405	6.00"	6.88"	1 1/4 - 7	4.00"	5000 LBS.	
MEDIUM DUTY	79-AV1M-200	79-AV1M-205	1.25"	3.50"	3/8 - 16	2.00"	400 LBS.	
	79-AV2M-200	79-AV2M-205	1.88"	3.75"	1/2 - 13	2.00"	1000 LBS.	
	79-AV3M-200	79-AV3M-205	2.50"	3.88"	5/8 - 11	2.00"	1800 LBS.	
	79-AV4M-200	79-AV4M-205	3.00"	4.13"	3/4 - 10	2.00"	2500 LBS.	
	79-AV5M-350	79-AV5M-355	4.00"	6.00"	1 - 8	3.50"	4500 LBS.	
	79-AV6M-400	79-AV6M-405	6.00"	6.88"	1 1/4 - 7	4.00"	10,000 LBS.	
HEAVY DUTY	79-AV1H-200	79-AV1H-205	1.25"	3.50"	3/8 - 16	2.00"	995 LBS.	
	79-AV2H-200	79-AV2H-205	1.88"	3.75"	1/2 - 13	2.00"	2400 LBS.	
	79-AV3H-200	79-AV3H-205	2.50"	3.88"	5/8 - 11	2.00"	4400 LBS.	
	79-AV4H-200	79-AV4H-205	3.00"	4.13"	3/4 - 10	2.00"	6500 LBS.	
	79-AV5H-350	79-AV5H-355	4.00"	6.00"	1 - 8	3.50"	11,800 LBS.	
	79-AV6H-400	79-AV6H-405	6.00"	6.88"	1 1/4 - 7	4.00"	27,100 LBS.	

THREADED INSERT

Metric sizes are available, please call.

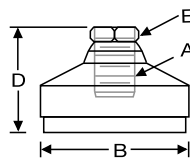

		THREADED INSERT PART NUMBERS		PRIMARY DIMENSIONS		MOUNTING	MAXIMUM STATIC LOAD (LBS.)
		STEEL	STAINLESS STEEL	BASE DIA. "D"	LENGTH "T"		
LIGHT DUTY	79-AV1L-00	79-AV1L-05	1.25"	1.50"	3/8 - 16	50 LBS.	
	79-AV2L-00	79-AV2L-05	1.88"	1.75"	1/2 - 13	120 LBS.	
	79-AV3L-00	79-AV3L-05	2.50"	1.88"	5/8 - 11	220 LBS.	
	79-AV4L-00	79-AV4L-05	3.00"	2.13"	3/4 - 10	325 LBS.	
	79-AV5L-00	79-AV5L-05	4.00"	2.50"	1 - 8	590 LBS.	
	79-AV6L-00	79-AV6L-05	6.00"	2.88"	1 1/4 - 7	1350 LBS.	
MEDIUM DUTY	79-AV1M-00	79-AV1M-05	1.25"	1.50"	3/8 - 16	100 LBS.	
	79-AV2M-00	79-AV2M-05	1.88"	1.75"	1/2 - 13	240 LBS.	
	79-AV3M-00	79-AV3M-05	2.50"	1.88"	5/8 - 11	440 LBS.	
	79-AV4M-00	79-AV4M-05	3.00"	2.13"	3/4 - 10	650 LBS.	
	79-AV5M-50	79-AV5M-05	4.00"	2.50"	1 - 8	1180 LBS.	
	79-AV6M-00	79-AV6M-05	6.00"	2.88"	1 1/4 - 7	2710 LBS.	
HEAVY DUTY	79-AV1H-00	79-AV1H-05	1.25"	1.50"	3/8 - 16	250 LBS.	
	79-AV2H-00	79-AV2H-05	1.88"	1.75"	1/2 - 13	600 LBS.	
	79-AV3H-00	79-AV3H-05	2.50"	1.88"	5/8 - 11	1180 LBS.	
	79-AV4H-00	79-AV4H-05	3.00"	2.13"	3/4 - 10	1625 LBS.	
	79-AV5H-50	79-AV5H-05	4.00"	2.50"	1 - 8	2950 LBS.	
	79-AV6H-00	79-AV6H-05	6.00"	2.88"	1 1/4 - 7	6775 LBS.	

LEVELING MOUNTS ANTI-VIBRATION

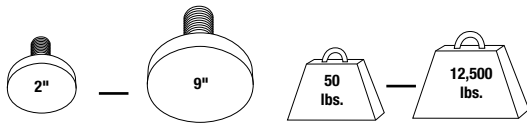

Base diameter range

Static load range
(per mount)

MIGHTY MOUNT™

Material:

Threaded stud – steel, zinc plate
Base – steel, safety yellow powder coat

- Meets OSHA anchoring standards.
- Rugged steel housing.
- High density non-skid base.



PART NUMBER	PRIMARY DIMENSIONS		MOUNTING		STATIC LOAD	
	BASE DIA. "D"	BASE HEIGHT "H"	THREAD SIZE "S"	THREAD LENGTH "L"	MINIMUM (LBS.)	MAXIMUM (LBS.)
79-5028A	2.00"	1.00"	1/4 - 28	1.75"	50 LBS.	300 LBS.
79-5016A	2.00"	1.00"	3/8 - 16	3.00"	50 LBS.	300 LBS.
79-5024B	2.00"	1.00"	3/8 - 24	3.00"	50 LBS.	300 LBS.
79-80163	3.00"	1.50"	3/8 - 16	3.00"	300 LBS.	700 LBS.
79-80243	3.00"	1.50"	3/8 - 24	3.00"	300 LBS.	700 LBS.
79-80136	3.00"	1.50"	1/2 - 13	6.00"	300 LBS.	700 LBS.
79-120135	5.00"	1.50"	1/2 - 13	5.00"	500 LBS.	2000 LBS.
79-120118	5.00"	1.50"	5/8 - 11	8.00"	500 LBS.	2000 LBS.
79-160135	6.00"	1.63"	1/2 - 13	5.00"	1000 LBS.	4500 LBS.
79-160105	6.00"	1.63"	5/8 - 11	5.00"	1000 LBS.	4500 LBS.
79-160108	6.00"	1.63"	3/4 - 10	8.00"	1000 LBS.	4500 LBS.
79-230105	9.00"	2.50"	3/4 - 10	5.00"	4000 LBS.	12,500 LBS.
79-230148	9.00"	2.50"	1 - 14	8.00"	4000 LBS.	12,500 LBS.

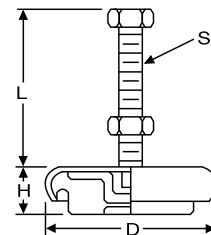

THREAD ENDS

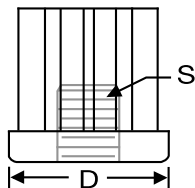

- Easy installation.
- Durable construction.
- Metric available (please call).

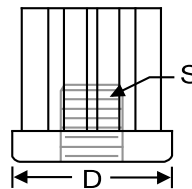

PART NUMBER	THREAD SIZE "S"	OUTSIDE DIAMETER "D"	TUBE GAUGE / SHAPE	TUBE DIAMETER	TUBE WALL THICKNESS	MAX. STATIC LOAD
79-TE1-2A	3/8 - 16	1.50" Square	16 gauge Square	1.50" Square	.065"	1500 lbs.
79-TE1-2B	1/2 - 13					
79-TE1-2C	5/8 - 11					
79-TE1-2D	3/4 - 10					
79-TE1-3A	3/8 - 16	1.50" Square	11 gauge Square	1.50" Square	.120"	1500 lbs.
79-TE1-3B	1/2 - 13					
79-TE1-3C	5/8 - 11					
79-TE1-3D	3/4 - 10					
79-TE2-1A	3/8 - 16	2.00" Square	16 gauge Square	2.00" Square	.065"	2000 lbs.
79-TE2-1B	1/2 - 13					
79-TE2-1C	5/8 - 11					
79-TE2-1D	3/4 - 10					
79-TE2-3A	3/8 - 16	2.00" Square	11 - 12 gauge Square	2.00" Square	.109" / .120"	2000 lbs.
79-TE2-3B	1/2 - 13					
79-TE2-3C	5/8 - 11					
79-TE2-3D	3/4 - 10					

PART NUMBER	THREAD SIZE "S"	OUTSIDE DIAMETER "D"	TUBE GAUGE / SHAPE	TUBE DIAMETER	TUBE WALL THICKNESS	MAX. STATIC LOAD
79-TE1-1A	3/8 - 16	1.50" Round	16 gauge Round	1.50" Round	.065"	1500 lbs.
79-TE1-1B	1/2 - 13					
79-TE1-1C	5/8 - 11					
79-TE1-1D	3/4 - 10					
79-TE2-2A	3/8 - 16	2.00" Round	11 gauge Round	2.00" Round	.120"	2000 lbs.
79-TE2-2B	1/2 - 13					
79-TE2-2C	5/8 - 11					
79-TE2-2D	3/4 - 10					

Material: Glass filled nylon with brass insert

LEVELING MOUNTS, ANTI-VIBRATION

LEVELING MOUNTS

ECONOMY SERIES

GLIDE-RITE™

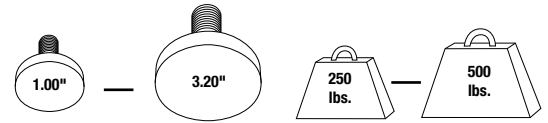

Base diameter range

Static load range
(per mount)

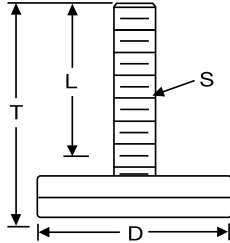

- Economical design with capped base.
- Gliding thermo plastic or non-skid elastomer base.
- No articulation.

Material: Steel - zinc, plate or stainless steel - plain



PART NUMBERS				PRIMARY DIMENSIONS		MOUNTING		MAXIMUM STATIC LOAD (LBS.)		
Steel		Stainless Steel		BASE DIA. "D"	LENGTH "T"	THREAD SIZE "S"	THREAD LENGTH "L"			
Glide	Non Skid	Glide	Non-Skid							
79-001-G	79-001-NS	79-501-G	79-501-NS	1.20"	2.25"	10 - 24	1.50"	250 LBS.		
79-002-G	79-002-NS	79-502-G	79-502-NS			1/4 - 20				
79-003-G	79-003-NS	79-503-G	79-503-NS			5/16 - 18				
79-004-G	79-004-NS	79-504-G	79-504-NS	2.03"	3.00"	5/16 - 18	2.00"	250 LBS.		
79-005-G	79-005-NS	79-505-G	79-505-NS			3/8 - 16				
79-006-G	79-006-NS	79-506-G	79-506-NS	2.40"	3.00"	3/8 - 16	2.00"	250 LBS.		
79-007-G	79-007-NS	79-507-G	79-507-NS			5.00"			3/8 - 16	4.00"
79-008-G	79-008-NS	79-508-G	79-508-NS			3.00"			1/2 - 13	2.00"
79-009-G	79-009-NS	79-509-G	79-509-NS			5.00"			1/2 - 13	4.00"
79-010-G	79-010-NS	79-510-G	79-510-NS	2.80"	3.13"	1/2 - 13	2.00"	500 LBS.		
79-011-G	79-011-NS	79-511-G	79-511-NS			5.13"			1/2 - 13	4.00"
79-012-G	79-012-NS	79-512-G	79-512-NS			3.13"			5/8 - 11	2.00"
79-013-G	79-013-NS	79-513-G	79-513-NS			5.13"			5/8 - 11	4.00"
79-014-G	79-014-NS	79-514-G	79-514-NS	3.19"	5.13"	1/2 - 13	4.00"	500LBS.		
79-015-G	79-015-NS	79-515-G	79-515-NS			7.13"			1/2 - 13	6.00"
79-016-G	79-016-NS	79-516-G	79-516-NS			5.13"			5/8 - 11	4.00"
79-017-G	79-017-NS	79-517-G	79-517-NS			7.13"			5/8 - 11	6.00"

HEX-GLIDE

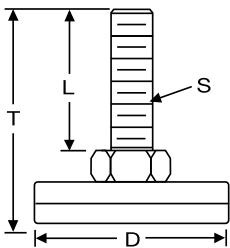

- Similar to above with hex adjustable on the stud.
- No articulation.
- Steel only.



PART NUMBERS		PRIMARY DIMENSIONS		MOUNTING		MAXIMUM STATIC LOAD (LBS.)
Steel		BASE DIA. "D"	LENGTH "T"	THREAD SIZE "S"	THREAD LENGTH "L"	
Glide	Non Skid					
79-WG1-2010-G	79-WG1-2010-NS	1.00"	1.00"	1/4 - 20	1.00"	250 LBS.
79-WG1-1810-G	79-WG1-1810-NS		1.00"	5/16 - 18	1.00"	
79-WG3-1810-G	79-WG3-1810-NS	1.38"	1.69"	5/16 - 18	1.00"	250 LBS.
79-WG3-1615-G	79-WG3-1615-NS		2.19"	3/8 - 16	1.50"	
79-WG3-1625-G	79-WG3-1625-NS		3.19"	3/8 - 16	2.50"	
79-WG3-1315-G	79-WG3-1315-NS		2.19"	1/2 - 13	1.50"	
79-WG3-1325-G	79-WG3-1325-NS	1.69"	3.19"	1/2 - 13	2.50"	250 LBS.
79-WG4-1615-G	79-WG4-1615-NS		2.19"	3/8 - 16	1.50"	
79-WG4-1625-G	79-WG4-1625-NS		3.19"	3/8 - 16	2.50"	
79-WG4-1315-G	79-WG4-1315-NS		2.19"	1/2 - 13	1.50"	
79-WG4-1325-G	79-WG4-1325-NS	1.69"	3.19"	1/2 - 13	2.50"	250 LBS.

Material: Steel - zinc, plate

LEVELING MOUNTS ECONOMY SERIES

- For light-duty applications.
- Economical design.
- No articulation.

PART NUMBER	PRIMARY DIMENSIONS			MOUNTING	
	BASE DIA. (FLATS) "D"	TOTAL LENGTH "T"	CAP HEIGHT "C"	THREAD SIZE "S"	THREAD LENGTH "L"
79-S1-20-100	.94"	1.25"	.19"	1/4 - 20	1.00"
79-S1-20-125		1.50"		1/4 - 20	1.25"
79-S1-18-100		1.25"		5/16 - 18	1.00"
79-S2-20-150	1.07"	1.75"	.19"	1/4 - 20	1.50"
79-S2-20-200		2.25"		1/4 - 20	2.00"
79-S2-18-150		1.75"		5/16 - 18	1.50"
79-S2-18-200		2.25"		5/16 - 18	2.00"
79-S3-20-100	1.38"	1.25"	.15"	1/4 - 20	1.00"
79-S3-18-100		1.25"		5/16 - 18	1.00"
79-S3-16-150		1.75"		3/8 - 16	1.50"
79-S3-16-200		2.25"		3/8 - 16	2.00"
79-S3-16-250		2.75"		3/8 - 16	2.50"
79-S3-13-150		1.75"		1/2 - 13	1.50"
79-S3-13-200		2.25"		1/2 - 13	2.00"
79-S3-13-250		2.75"		1/2 - 13	2.50"
79-S3-13-300		3.25"		1/2 - 13	3.00"
79-S4-20-150		1.38"		1.75"	.31"
79-S4-20-200	2.25"		1/4 - 20	2.00"	
79-S4-18-150	1.75"		5/16 - 18	1.50"	
79-S4-18-200	2.25"		5/16 - 18	2.00"	
79-S4-18-250	2.75"		5/16 - 18	2.50"	
79-S4-16-150	1.75"		3/8 - 16	1.50"	
79-S4-16-200	2.25"		3/8 - 16	2.00"	
79-S4-16-250	2.75"		3/8 - 16	2.50"	
79-S4-13-150	1.75"		1/2 - 13	1.50"	
79-S4-13-200	2.25"		1/2 - 13	2.00"	
79-S4-13-250	2.75"		1/2 - 13	2.50"	
79-S4-13-300	3.25"		1/2 - 13	3.00"	

STAMPED BASE

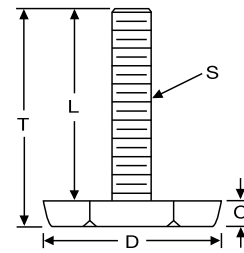

Material:
Steel - zinc, plated
(black oxide available)

- Rugged, yet economical.
- No articulation.

PART NUMBER	PRIMARY DIMENSIONS		MOUNTING		MAX. STATIC LOAD
	BASE DIA. (FLATS) "D"	TOTAL LENGTH "T"	THREAD SIZE "S"	THREAD LENGTH "L"	
79-H-1Z	.56"	1.09"	1/4 - 20	1.00"	1000 LBS.
79-H-2Z	.75"	1.63"	5/16 - 18	1.50"	2300 LBS.
79-H-3Z	.88"	1.66"	3/8 - 16	1.50"	3750 LBS.
79-H-4Z	.88"	2.66"	3/8 - 16	2.50"	3750 LBS.
79-H-5Z	1.07"	2.69"	1/2 - 13	2.50"	5000 LBS.

Material:
Steel - zinc, plated

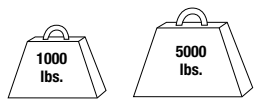

Static load range

HEX MOUNT

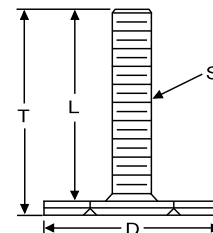

LEVELING MOUNTS BUMPERS AND FEET

URETHANE SELF-ADHESIVE BUMPERS

Head Styles



Cylindrical



Square



Tapered Square



Hemisphere

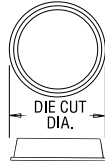

UL file number E83785



- Excellent skid-resistance.
- High coefficient of friction.
- Non-marring, non-staining material.
- High initial adhesion.
- UL flammability recognition: UL 94HB.
- 4 standard colors (see chart).
- Application specific material formulation and custom colors are available, please call.

SHAPE	URETHANE PART NUMBER	DIMENSIONS		STANDARD COLORS			
		HEAD HEIGHT	DIAMETER	CLEAR	BLACK	WHITE	GRAY
CYLINDRICAL	4041-00	.085"	.312"	X	—	—	—
	4053*	.125"	.400"	—	X	—	—
	4052-00	.140"	.495"	—	X	—	—
	4031-00	.125"	.500"	—	—	X	—
	4001-00	.140"	.500"	X	X	X	—
	4006-00	.250"	.500"	—	—	X	—
	4029-00	.325"	.500"	—	X	—	—
	4023-00	.160"	.750"	—	X	—	—
	4045-00	.197"	.819"	—	—	—	X
4047-00	.470"	.685"	—	X	—	—	
SQUARE	4007-00	.100"	.400" X .400" SQUARE	X	—	—	—
	4032-00	.120"	.500" X .500" SQUARE	—	X	—	—
TAPERED SQUARE	4009-00	.230"	.500" X .500" SQUARE	—	X	—	—
	4019-00	.300"	.800" X .800" SQUARE	—	X	—	—
HEMISPHERE	4042-00	.150"	.375"	X	—	—	—
	4002-00	.200"	.437"	X	X	X	—

SNAP-IN BUMPER

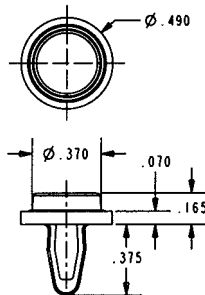

- Quick and easy hand installation.
- High shear force and holding strength.
- Ideal for applications where conditions will not allow a self-stick bumper:
 - Moisture
 - Uneven surfaces

SNAP-IN BUMPER PART NUMBER	BUMPER DIMENSIONS		MOUNTING	
	HEIGHT	DIAMETER	HOLE DIAMETER	PANEL THICKNESS
8202-00-9909	.235"	.370"	.184"-.190"	.030"-.090"

Materials: Nylon base, Urethane bumper.

Color: Black

Note: Listed dimensions are nominal.

LEVELING MOUNTS BUMPERS AND FEET

- Acrylic based adhesive yields excellent long-term adhesion.
- Base is solvent and ultra-violet light resistant.
- High shear strength.
- 4 standard colors (see chart)
- Application specific material formulations and custom colors are available, please call.

PVC SELF-ADHESIVE BUMPERS

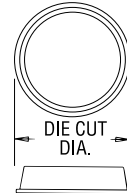

SHAPE	PVC PART NUMBER	DIMENSIONS		STANDARD COLORS			
		HEAD HEIGHT	DIAMETER	BLACK	WHITE	GRAY	NATURAL
CYLINDRICAL	5005-01-00	.070"	.500"	X	X	—	X
	5026-01-00	.090"	.500"	X	—	—	—
	5031-01-00	.115"	.500"	X	—	—	—
	5001-01-00	.140"	.500"	X	—	X	X
	5006-01-00	.250"	.500"	X	—	—	X
	5029-01-00	.325"	.500"	—	—	X	—
	5034-01-00	.115"	.645"	X	—	—	—
	5011-01-00	.400"	.645"	X	X	—	—
	5025-01-00	.250"	.830"	X	—	—	—
SQUARE	5033-01-00	.185"	.375" X .375" SQUARE	X	—	—	—
	5003-01-00	.200"	.500" X .500" SQUARE	X	—	—	—
	5010-01-00	.260"	.510" X .510" SQUARE	X	—	—	—
	5022-01-00	.130"	.645" X .645" SQUARE	X	—	—	—
	5004-01-00	.340"	.760" X .760" SQUARE	X	—	—	—
TAPERED SQUARE	5032-01-00	.120"	.500" X .500" SQUARE	X	—	—	—
	5019-01-00	.300"	.810" X .810" SQUARE	X	—	—	—
HEMISPHERE	5002-01-00	.200"	.437"	X	—	—	—
	5015-01-00	.320"	.645"	X	—	—	—
CIRCULAR DEPRESSED	5017-01-00	.400"	.875"	X	—	—	—
	5030-01-00	.560"	2.00"	—	X	—	—
CYLINDRICAL CONCAVE	50918-01-00	.140"	.500"	—	—	X	—

Head Shapes

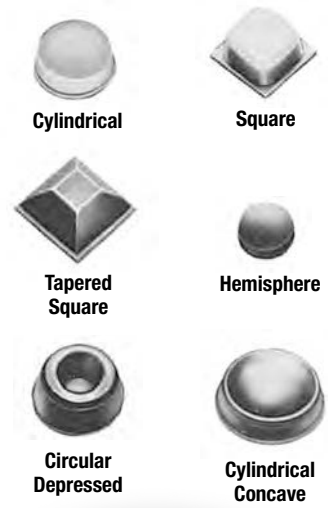

For detailed material specifications and product strength guidelines.
www.clancey.com



WIRE MANAGEMENT PRODUCTS

See our complete line of wire management products pages 299 to 321.



LEVELING MOUNTS, BUMPERS AND FEET

LEVELING MOUNTS BUMPERS AND FEET

HEYCO® FEETS OF STRENGTH™

PUSH RIVET MOUNT

Material:
Polypropylene/
Elastomer blend

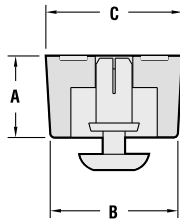

- Quick, easy hand installation.
- 17 sizes with various height combinations.
- Can be released with access to the blind side of the panel.

PART NUMBER	DIMENSIONS			MOUNTING	
	OVERALL HEIGHT "A"	TOP DIAMETER "B"	BOTTOM DIAMETER "C"	PANEL THICKNESS RANGE	HOLE DIAMETER
2517	.217"	.531"	.559"	.031" - .071"	.122"
2518	.217"	.531"	.559"	.071" - .110"	.122"
2519	.157"	.394"	.425"	.024" - .039"	.142"
2520	.157"	.394"	.425"	.039" - .079"	.142"
2521	.157"	.394"	.425"	.079" - .118"	.142"
2522	.165"	.787"	.827"	.031" - .071"	.161"
2523	.165"	.787"	.827"	.071" - .110"	.161"
2524	.165"	.787"	.827"	.110" - .146"	.161"
2525	.165"	.787"	.827"	.150" - .189"	.161"
2526	.236"	.787"	.827"	.031" - .071"	.161"
2527	.236"	.787"	.827"	.075" - .110"	.161"
2528	.236"	.787"	.827"	.114" - .157"	.161"
2529	.315"	.787"	.827"	.031" - .079"	.161"
2530	.315"	.787"	.827"	.083" - .118"	.161"
2531	.354"	.551"	.591"	.024" - .039"	.161"
2532	.354"	.551"	.591"	.039" - .079"	.161"
2533	.354"	.551"	.591"	.079" - .118"	.161"

DRIVE PIN MOUNT

Material:
Ethylene vinyl acetate

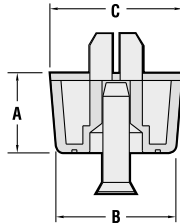

- Skid and vibration resistant.

PART NUMBER	DIMENSIONS			MOUNTING	
	OVERALL HEIGHT "A"	TOP DIAMETER "B"	BOTTOM DIAMETER "C"	PANEL THICKNESS RANGE	HOLE DIAMETER
2543	.197"	.906"	.984"	.031" - .059"	.299"
2544	.236"	.787"	.827"	.197" - .315"	.303"
2545	.394"	.709"	.787"	.031" - .059"	.303"
2547	.472"	.709"	.787"	.031" - .047"	.319"
2549	.591"	.709"	.787"	.031" - .047"	.319"
2551	.709"	.709"	.787"	.031" - .047"	.319"

SCREW-RIVET MOUNT

Material:
Ethylene vinyl acetate
acetyl screw

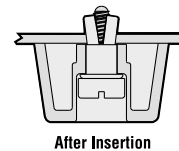
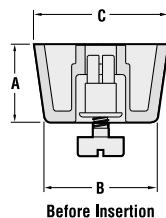

Other styles
similar after
insertion.

- Push screw head to install.
- Use slotted screwdriver to remove.

PART NUMBER	DIMENSIONS			MOUNTING	
	OVERALL HEIGHT "A"	TOP DIAMETER "B"	BOTTOM DIAMETER "C"	PANEL THICKNESS RANGE	HOLE DIAMETER
2538	.551"	.787"	.945"	.039" - .091"	.197"